



78 Wilsdon Way, Kidlington, Oxon, OX5 1TX

£1,100 PCM - 9th January 2026.

- One bedroom
- Garden
- Council Tax B
- Furnished
- Parking for one car
- Mains electricity and water

- Electric heating
- EPC rating D

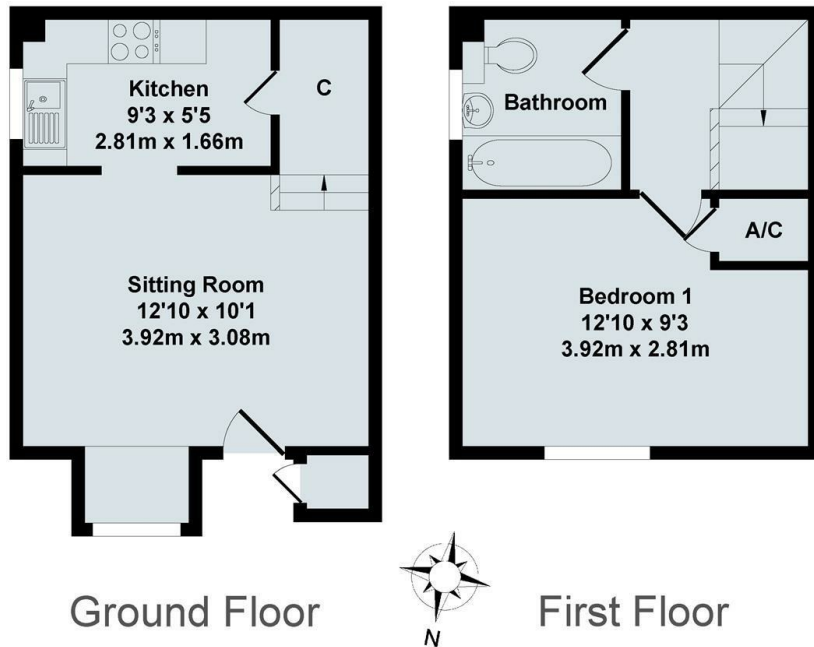

Total Approx. Floor Area 425 Sq.Ft. (39.50 Sq.M.)
All items illustrated on this plan are included in the "Total Approx Floor Area"

Directions

Viewings

Viewings by arrangement only. Call 01865 515900 to make an appointment.

Council Tax Band

B

EPC Rating:

D

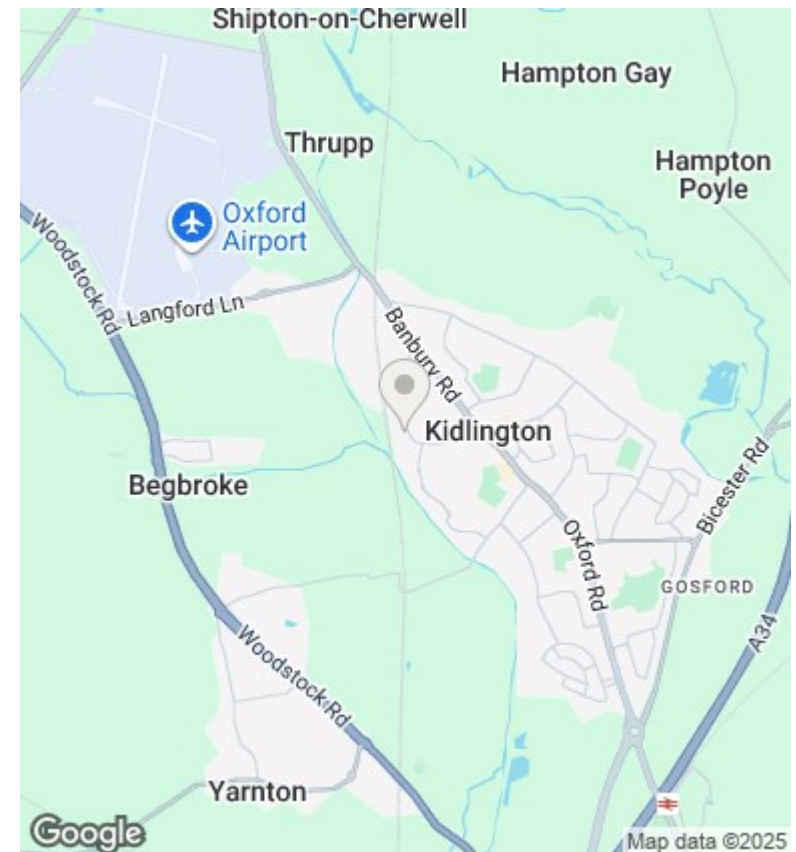

Energy Efficiency Rating		
	Current	Potential
Very energy efficient - lower running costs		
(92 plus) A		95
(81-91) B		
(69-80) C		
(55-68) D	61	
(39-54) E		
(21-38) F		
(1-20) G		
Not energy efficient - higher running costs		
England & Wales	EU Directive 2002/91/EC	